

REPORT TITLE:	NORTH BARRIE PAR - RETROFIT PROJECT – ST. JOSEPH’S CATHOLIC HIGH SCHOOL
REPORT NUMBER:	9. 8) 04-2013
DESTINATION:	Board Meeting #04
DATE:	Wednesday, February 6, 2013
AUTHOR OF REPORT:	Glenn Clarke, Controller of Plant
TYPE OF REPORT:	Information

Background:

1. Over the past few years, upgrades have been made to our secondary school program spaces with St. Joan of Arc Catholic High School, St. Peter’s Catholic Secondary School and St. Theresa’s Catholic High School retrofits being completed this past year. St Joseph’s Catholic High School (SJO) is next on the list for retrofits followed by Jean Vanier Catholic High School. This report provides an update on the SJO project.

2. The last addition and retrofit project at SJO was completed in 2001 and due to funding limitations at that time, the full scope of work could not be completed. Specifically, areas of the school need a life cycle retrofit to upgrade the building components such as lighting, boiler and HVAC, painting, lockers, etc. As well, program spaces need to be modified to meet the curriculum requirements including a music room, drama/dance and special education. A safe schools modification is needed for the front office area as there is no direct office supervision of the main entrance and corridor. Another area for building security upgrades are with the installation of corridor doors so that community use access is restricted to defined areas. At this time, the majority of the school is accessible when public events are held in the gym. The school community and Board also need more meeting rooms and the surplus classroom spaces in the school provide an opportunity for this purpose.

Comments:

3. Plant department, program and SJO school staff have defined the project scope of work and the project architect has been preparing the design concepts to include:
 - a) Facility retrofits for the building components;
 - b) Upgraded program spaces for music, dance/drama and special education;
 - c) Reconfigured office area to provide for enhanced school supervision;
 - d) Meeting room spaces on the second floor for small and large meetings. The small meeting room is approximately 750 sq. ft. (standard classroom size) and the other room is approximately 2100 sq. ft. (three classrooms consolidated into one room). The larger meeting room is roughly 50% larger than the general meeting room at 80 Bell Farm; and
 - e) Additional parking will be made available where the portables had been located (to the east of the south wing).

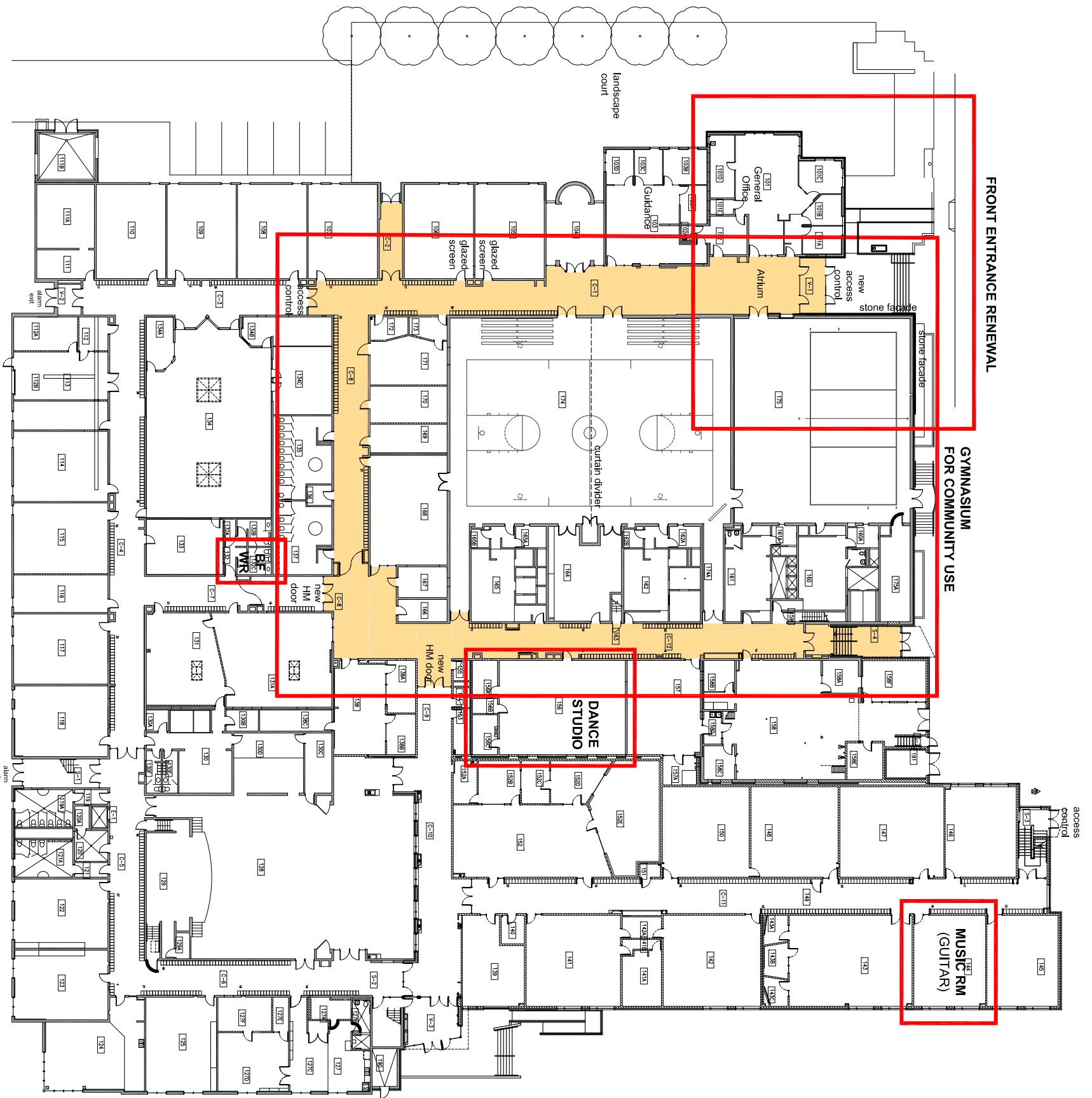

APPENDIX A - 2nd floor plan

